



swiss-belRESIDENCES
RIVAN

Live Free



First-Internationally Branded
Apartments in **R7** New Capital

" SAUDI-EGYPTIAN PARTNERSHIP"

Owning Company of Swiss-Belresidences Rivan

Altameer Arabian Group of companies operates across multiple sectors, including engineering, construction, telecommunications, medical, and agriculture. It focuses on delivering top-tier products and services to satisfy clients and partners, with a solid reputation across the Gulf region and Egypt.



**MEET OUR
CHAIRMEN**



**“WE ARE ESTABLISHING A BRIDGE OF PRECIOUS
DEPENDABILITY”**

-Eng. Marzouk Mansour Chairman

“With extensive experience in real estate development and strong partnerships with major companies and consultancy firms across the globe, our Saudi Arabian and United Arab Emirates-based companies have unveiled a new vision to revolutionize real estate development in Egypt.

We believe that the ultimate goal of the real estate industry, rather than just developing residential, administrative, or commercial units, is to create a means for daily satisfaction via reconstruction for improvement and luxury.”



"STRENGTHENING THE SAUDI-EGYPTIAN PARTNERSHIP"

-Saudi Investment Representative and Board Member Eng. Salem Al Saudais

"Al Tameer Arabian is a collaboration and partnership between **Saudi and Egyptian partners in the Egyptian market**, owing to the strong ties that exist between the Kingdom of Saudi Arabia and the Arab Republic of Egypt, as well as the fostering of many Saudi investments in Egypt via investment companies and the Saudi Sovereign Fund.

We anticipate greater investments in the next years, not just in the real estate development sector, but also in other areas, such as agriculture, trade, construction, and manufacturing. Our work is confidently based on the visible cultural legacy and strong economic contacts between both nations and governments, which are supported by our experience and successes in the Kingdom since the early 1990s.



swiss-belRESIDENCES

RIVAN

CAIRO • EGYPT



Live Free

**We offer more than just a residence, it's a gateway to a new way of life.
Imagine a space that transcends the ordinary, where every corner holds the promise
of inspiration and innovation.**



INTERNATIONALLY BRANDED RESIDENCES IN RIVAN

Swiss-Belhotel International, a company with 18 Internationally known brands.

Founded in 1987 and headquartered in Hong Kong, Swiss-Belhotel International is recognized as one of the world's fastest-growing hotel management groups. With 135+ hotels in 20 countries, Swiss-Belhotel International provides professional and expert management services for hotels, resorts and residences.

The Group's distinct blend of Swiss hospitality and Asian-inspired service sets them apart. Each property carries the Swiss-Belhotel International hallmark, symbolizing quality and commitment to value. This dedication echoes their philosophy of "Passion and Professionalism™".



swiss-belhotel
INTERNATIONAL
HOTELS & RESORTS

BRANDED RESIDENCES

Leading the way
Defining the standards of
High-end Living.

Under the ownership of Al Tameer Arabian Group, and with the international standards of Swiss-Belhotel International, we are proud to announce Swiss-Belresidences Rivan.

THIS WILL BE THE FIRST INTERNATIONAL BRANDED RESIDENCES AT THE HEART OF THE NEW CAPITAL CITY IN CAIRO, EGYPT.

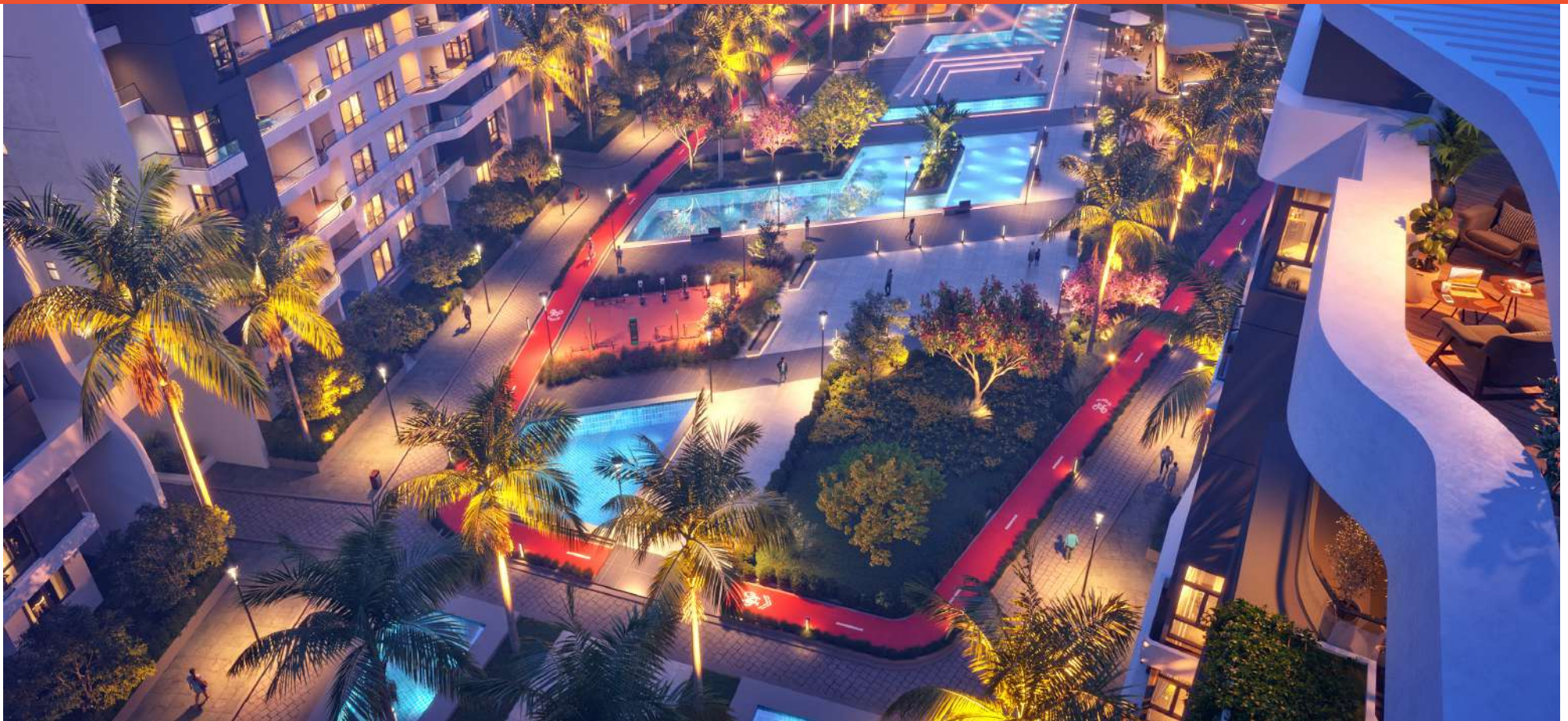

Live Free

LOCATION

Matters



Perfect location to live.

swiss-belRESIDENCES

RIVAN

Is located in R7 which is one of the most distinguished and important location in the **New Capital** as it is directly servicing the diplomatic district.

R7 is considered to be the golden district of the New Capital, it is close to the diplomatic area and all the major sites in the New Capital.

Neighbourhood

CAIRO INTL.AIRPORT
30mins

DIPLOMATIC AREA
10mins

ICONIC TOWER
15mins

NEW CAIRO
20mins

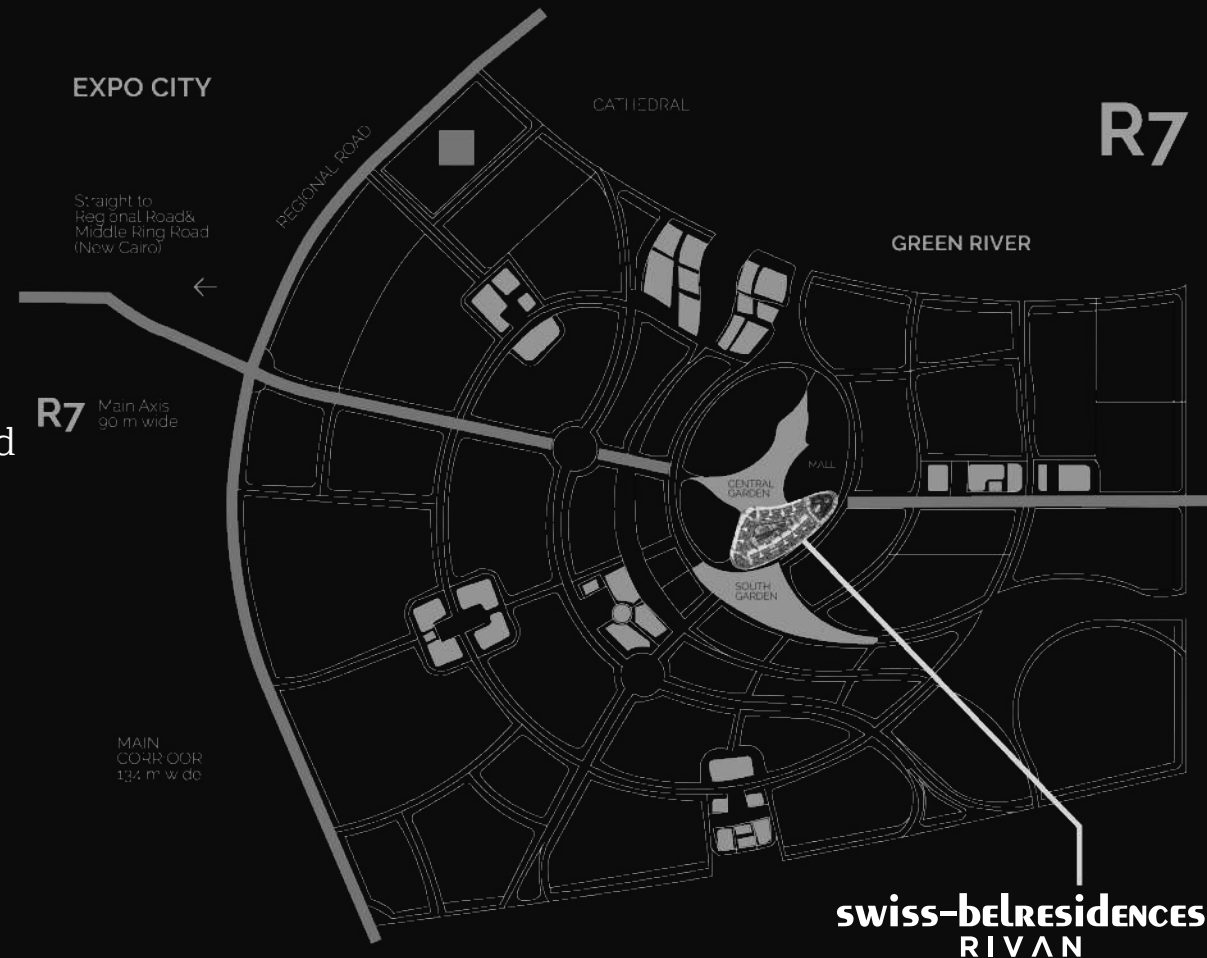

swiss-belRESIDENCES
RIVAN



Lobby Entrance

Laundry Service

Roof Lounge

Indoor Restaurant

Swimming Pool

Room Service

Spa

Housekeeping

Outdoor Restaurant

Gate 3 - Mall Entrance

Parks & Green Areas

Kids Area

Bicycle Lane

Jogging Lane

Entrance - Gate 2

Gym

Water Features

Gate 1



swiss-bel RESIDENCES RIVAN



- | | | | | | |
|---|---|--|---|---|--|
|  Central Park |  Water Features |  Roof Clubhouse |  Kids Area |  Swissbel Gated Entrance |  Entrance Gates |
|  South Park |  Parks & Green Areas |  Bicycle Lane |  Serviced Apartments |  Underground Parking |  Commercial Hub |



STYLIZED AMENITIES

At Swiss-Belresidences Rivan, every amenity is thoughtfully designed to provide not just comfort but a lifestyle of effortless elegance. Experience a new standard of living where your needs are met with sophistication and style.



ROOM SERVICE

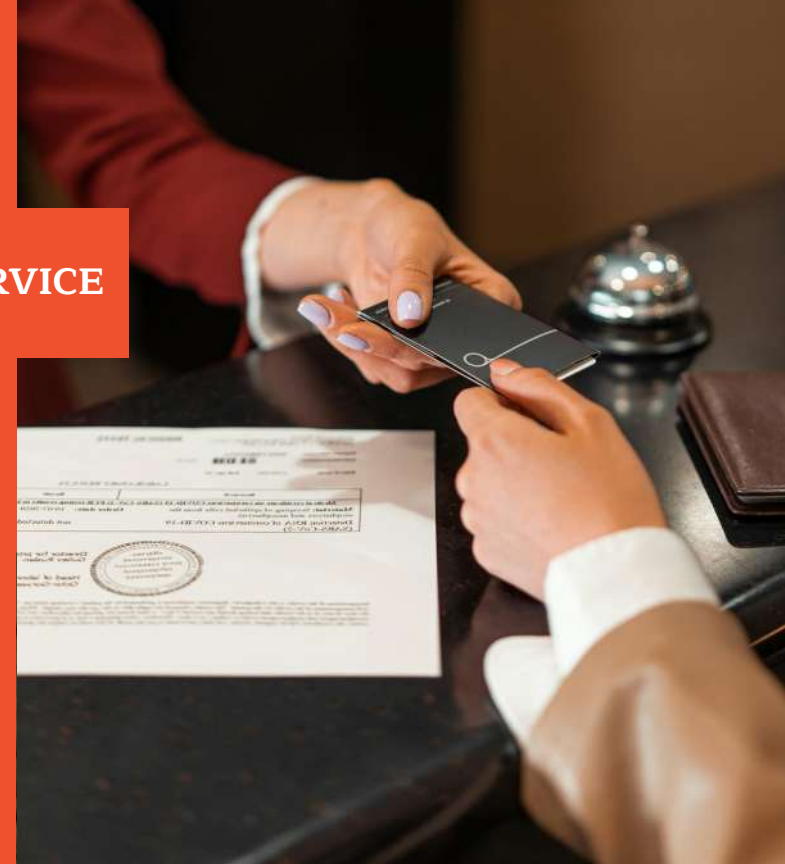

CONCIERGE SERVICE



HOUSE KEEPING

Welcome to your serene sanctuary, where comfort meets elegance. Swiss-Belresidences Rivan offers a harmonious blend of modern amenities and warm hospitality, creating a perfect retreat for you and your loved ones. Experience the ideal place to call home



LAUNDRY



DOOR MAN



ROOF LOUNGE



PARKS & GREEN AREAS



SPA



GYM

Unwind in beautifully designed spaces that invite relaxation, allowing you to escape the stresses of daily life and indulge in a truly restful experience. Your perfect getaway awaits.



BICYCLE LANES



SWIMMING POOLS

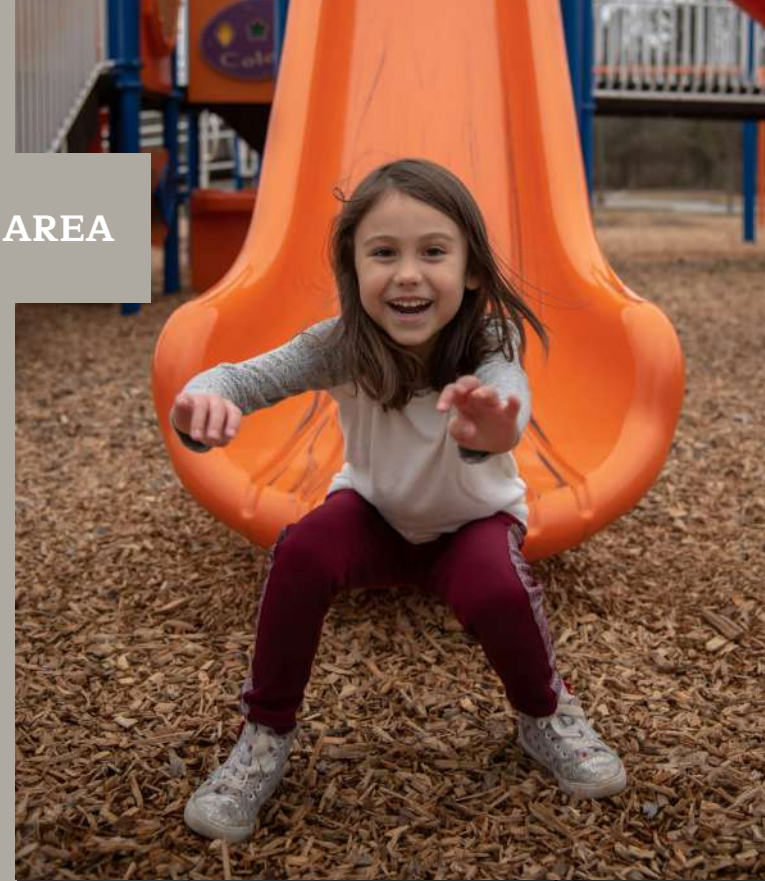

KIDS AREA

Unleash joy with our exceptional amenities, crafted for your ultimate comfort and leisure. From refreshing pools to serene gardens, each feature invites relaxation and connection. Experience a lifestyle where every day feels like a retreat!



WATER FEATURES

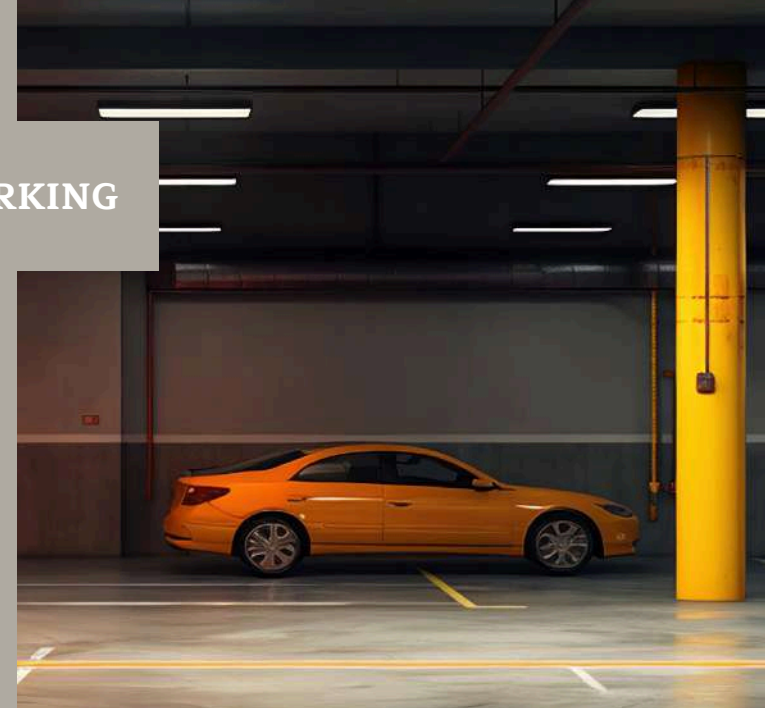

UNDERGROUND PARKING



SHOPPING MALL

The best and most iconic brands in Rivan's mall complex to guarantee you the best shopping experience.



SOLAR ENERGY

Solar energy panels allowing all Rivan residents to live eco friendly and minimize consumption.

● PRIVATE & SAFE COMMUNITY ● FOR FAMILIES



- Gated Community 24/7.
- Cars not allowed inside the community.
- Double security check points for branded residences.



MASTERING *Elegance*

Elegance enhanced by innovation. Enjoy high-end finishes, Central air conditioning, Solar powered systems and that are all put in place to refine your life at Swiss-Belresidences Rivan, New Capital.



swiss-belRESIDENCES RIVAN

Swiss-Belresidences Rivan offers a variety of units in different sizes and views across studios, apartments, duplexes, and linked villas. Making it an excellent choice for both investors and home seekers.



**Bringing Your Dream Home to Life:
Virtual Tours of Swiss-Belresidences Rivan**



Live Free

“Design is thinking made visual.”
— Saul Bass
Acclaimed American Designer

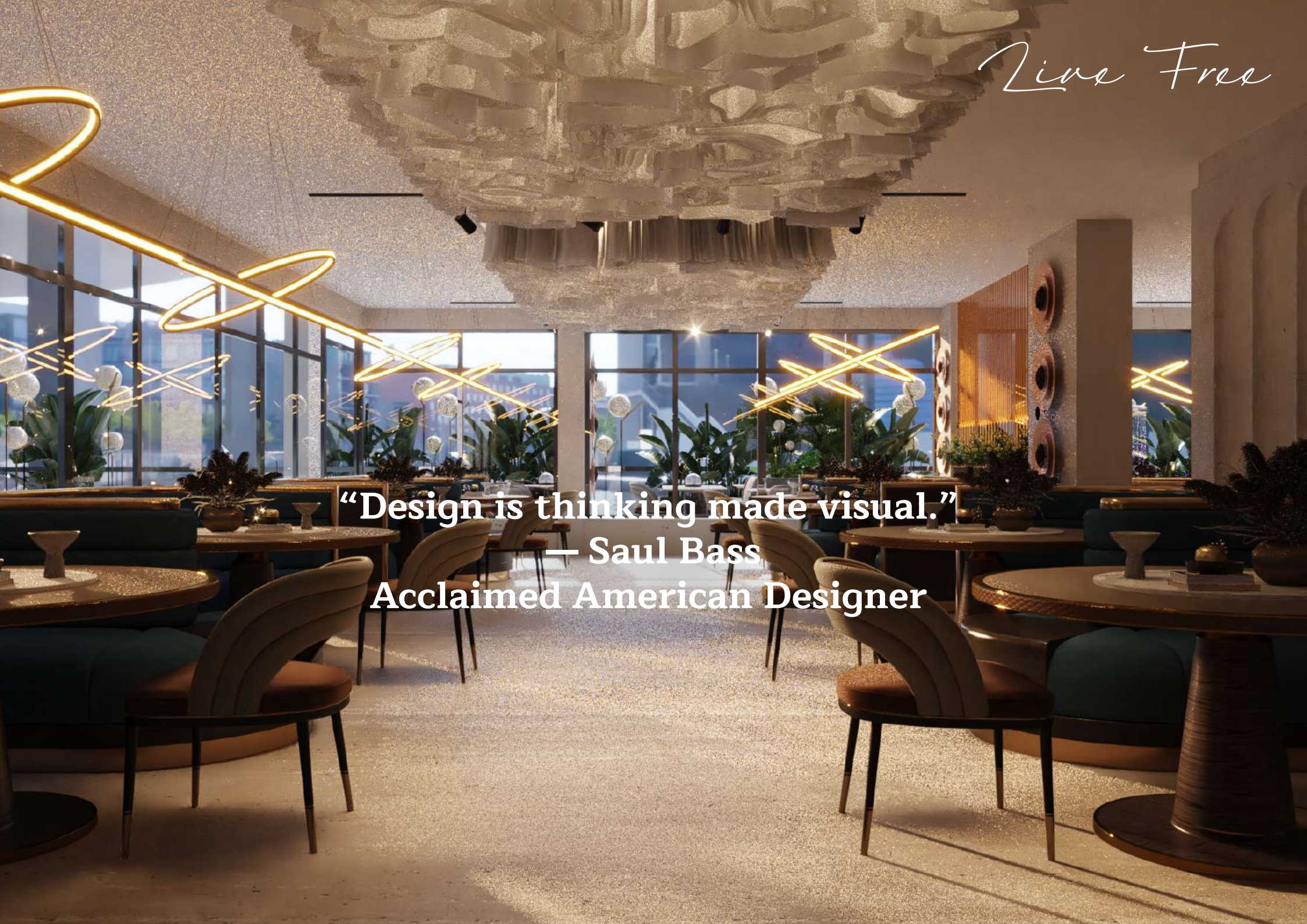

Live Free

**“Design is not for philosophy, it’s for life”
- Issey Miyake
Japanese Fashion Designer**





Live Free

Live Free

SERENE *Views*

Welcome to the ultimate life of exclusivity.





Swiss-Belresidences Rivan encompasses the latest technology in buildings and modern designs that will allow its residents to experience high-end living in an elite community at a prime location in the New Capital.

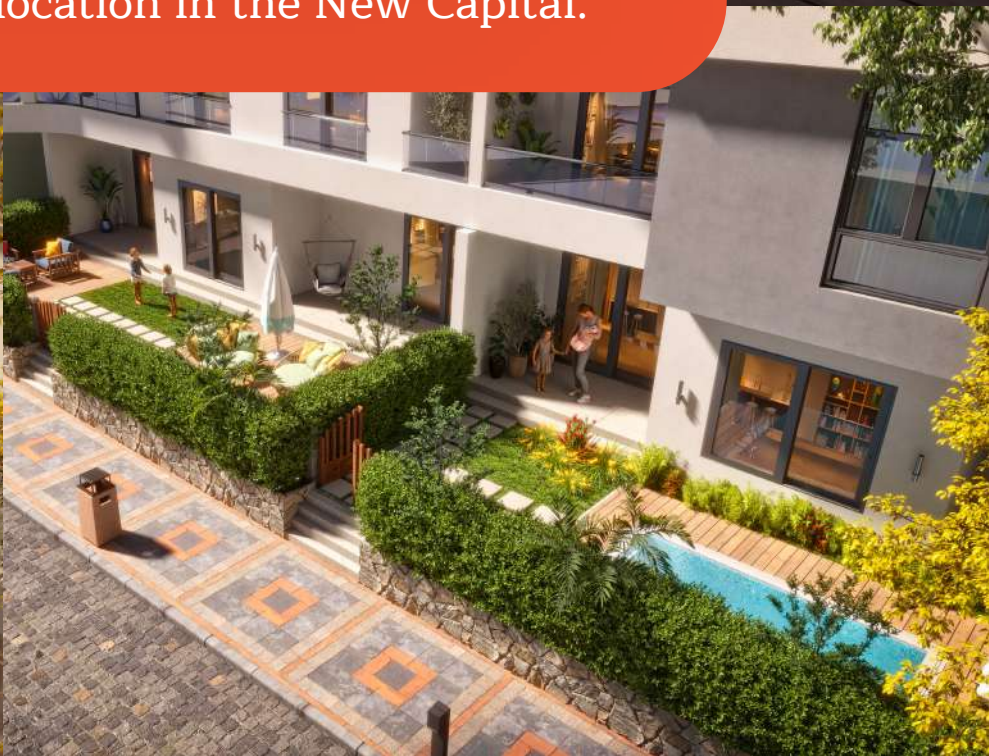

Live Free

We imagine the future, we plan for the long term and at the heart of it are the elements of life and convenience inspired by nature.



Live Free



GARDENS & GREENERY



BEYOND
ARCHITECTURE,
SWISS-BELRESIDENCES
RIVAN IS PURELY
INSPIRED BY
GREENS

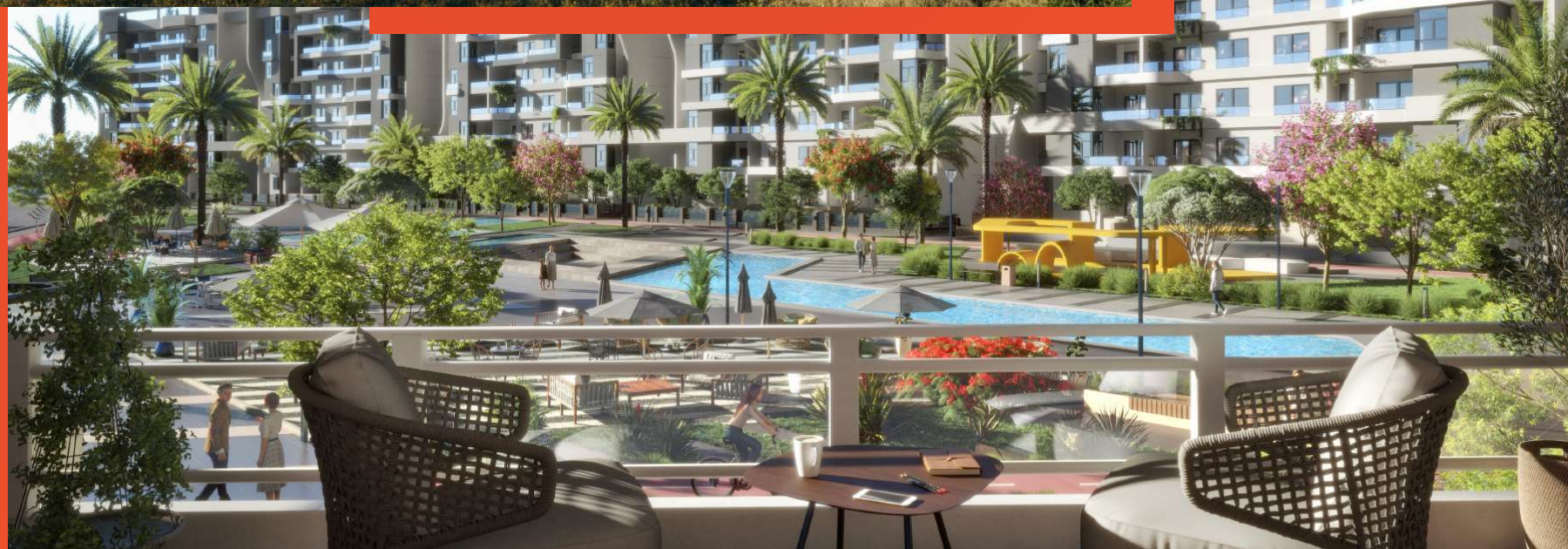



FLOOR

Plans

Where exceptional design meets unparalleled comfort, Swiss-Belresidences Rivan redefines the art of living.

THE INTERNATIONALLY BRANDED APARTMENTS

BUILDING 2

STUDIO
54m²-54m²

SPACE	AREA
BEDROOM	4.70X3.60
KITCHEN	1.70X1.30
BATHROOM	3.20X2.10
E-LOBBY	2.00X1.70
TOTAL AREA	54M ²

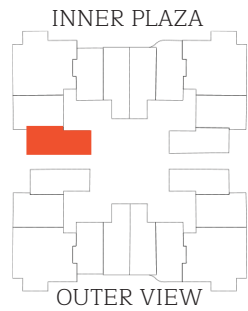

BUILDING NO.
FLOOR NO.
FLAT NO.

01B

BUILDING NO.
FLOOR NO.
FLAT NO.

10B

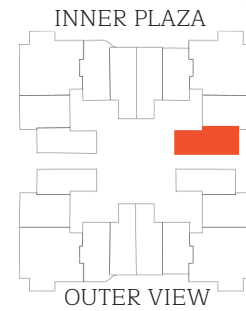

SPACE	AREA
BEDROOM	4.70X3.60
KITCHEN	1.70X1.30
BATHROOM	3.20X2.10
E-LOBBY	2.00X1.70
TOTAL AREA	54M ²



PRIVATE GATED COMMUNITY

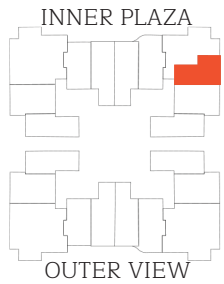

2-208B1



SPACE	AREA
BEDROOM	7.45X3.25
KITCHEN	1.60X1.10
BATHROOM	2.50X1.65
TERRACE	1.35X1.30
TOTAL AREA	54M ²

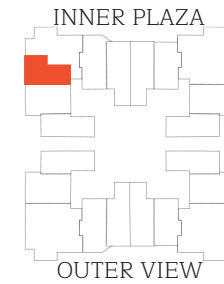

2-202B2



STUDIO
54m²-54m²



SAFE, CALM
& RELAXING

STUDIO
60m²



07B

SPACE	AREA
BEDROOM	4.80X1.30
KITCHEN	1.00X2.40
BATHROOM	2.50X2.10
E-LOBBY	2.80X1.30
TOTAL AREA	60M ²

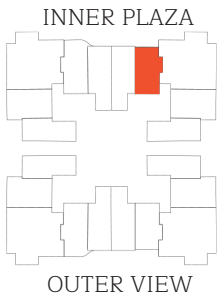

REFRESHING GREENS

BUILDING 2

INNER PLAZA

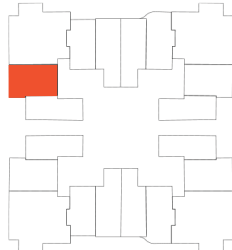

OUTER VIEW

O2B

SPACE	AREA
BEDROOM	4.00X2.90
KITCHEN	2.30X2.90
BATHROOM	2.80X1.70
LIVING ROOM	4.70X2.90
TOTAL AREA	64M ²



INNER PLAZA

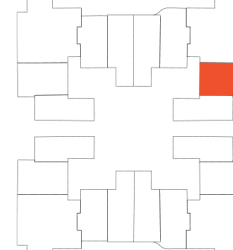

OUTER VIEW

O9B

SPACE	AREA
BEDROOM	4.00X2.90
KITCHEN	2.30X2.90
BATHROOM	2.80X1.70
LIVING ROOM	4.70X2.90
TOTAL AREA	64M ²



STUDIO
64m²-64m²

HIGH-END COMFORT



STUDIO
65m²

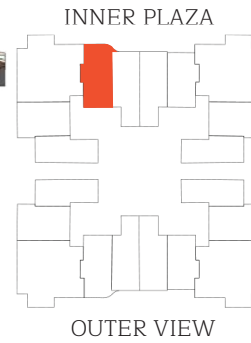

04B

SPACE	AREA
BEDROOM	4.80X4.20
KITCHEN	1.00X2.40
BATHROOM	2.50X2.10
TERRACE	4.70X1.20
E-LOBBY	2.80X1.30
TOTAL AREA	65M ²

CONTROLLED & MONITORED

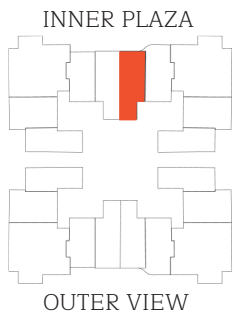

O6B

SPACE	AREA
BEDROOM	5.90X3.90
KITCHEN	2.70X2.30
BATHROOM	2.40X2.10
E-LOBBY	2.80X1.50
TOTAL AREA	67M ²



O5B

SPACE	AREA
BEDROOM	5.90X3.90
KITCHEN	2.70X2.30
BATHROOM	2.40X2.10
E-LOBBY	2.80X1.50
TOTAL AREA	67M ²

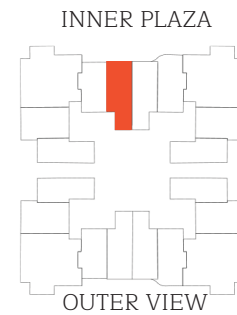

STUDIO
67m²-67m²



SERENE
AMBIENCE

1 BEDROOM
77m²-77m²



SPACE	AREA
BEDROOM	4.70X3.75
KITCHEN	1.95X0.60
BATHROOM 1	1.65X1.60
BATHROOM 2	2.85X1.80
LIVING ROOM	4.30X3.70
TERRACE	4.25X1.25
E-LOBBY	2.00X1.85
TOTAL AREA	77M ²





FRIENDLY COMMUNITY

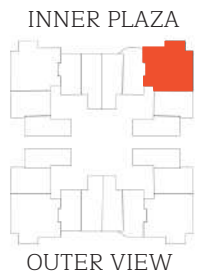

2-008A



SPACE	AREA
M.BEDROOM	4.70X3.80
BEDROOM	5.00X3.20
KITCHEN	2.70X2.30
BATHROOM 1	2.50X1.60
BATHROOM 2	2.50X1.60
E-LOBBY	1.60X1.30
TERRACE 1	4.30X2.85
TERRACE 2	1.30X1.20
TOTAL AREA	140M ²

2-003B

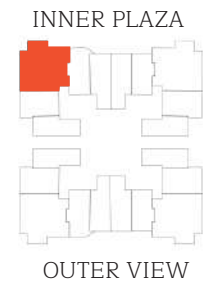

**2 BEDROOMS +
2 TERRACES
140M²-140M²**



GARDENS.

"To plant a garden is to believe in tomorrow."

- Audrey Hepburn

Famous Hollywood Actress

Live Free

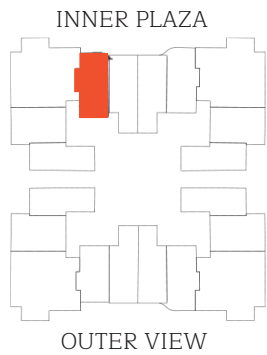

2-004B

SPACE	AREA
BEDROOM	4.50X4.50
KITCHEN	1.00X2.40
BATHROOM	2.50X2.10
E-LOBBY	2.80X1.50
GARDEN	25.00M
TOTAL AREA	55M ²



2-007B

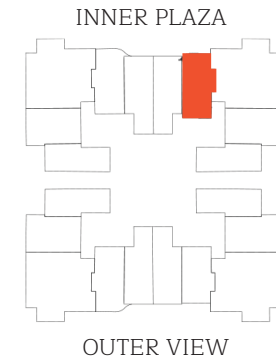

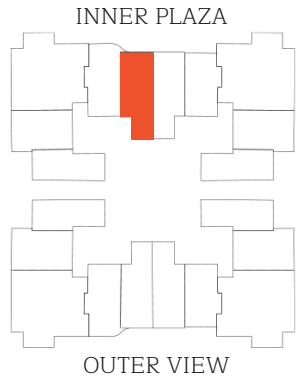

SPACE	AREA
BEDROOM	5.60X3.90
KITCHEN	2.30X1.00
BATHROOM	2.40X2.10
E-LOBBY	2.30X1.70
CORRIDOR	2.80X1.50
GARDEN	21.00M
TOTAL AREA	65M ²

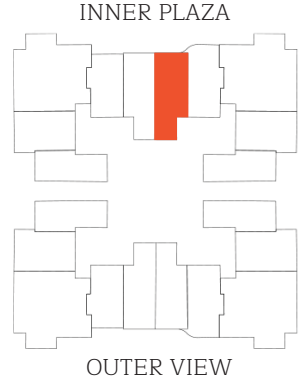

Live Free

Live Free

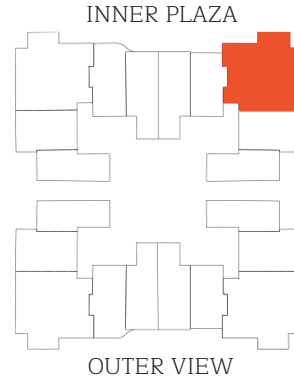
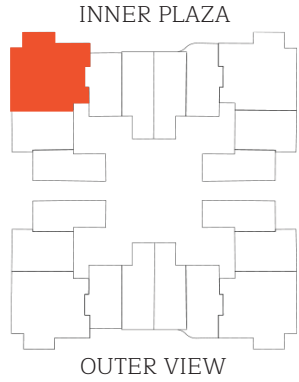

2-003B



2-008B

SPACE	AREA
BEDROOM 1	5.00X3.80
BEDROOM 2	4.90X3.30
M.BEDROOM	4.10X4.00
BATHROOM 1	3.10X1.90
BATHROOM 2	2.40X1.80
KITCHEN	1.70X1.20
E-LOBBY	2.10X1.30
LIVING	4.50X4.40
DRESSING	2.40X2.30
TERRACE	1.80X1.40
CORRIDOR	5.10X1.30
GARDEN	21.00M
TOTAL AREA	155M ²

OUR PARTNERS

•  DURAVIT • SAMSUNG •



ACE CONSULTING ENGINEERS
MOHARRAM.BAKHOUM

NOTES.